



5

## COLLECTION

The stool specimens for this test must be collected on three separate days. It is preferable, but not necessary, to collect on consecutive days but the final collection must be made within seven days of the first.

DAY 1 COLLECTION	DAY 2 COLLECTION
Use Contents from DAY 1 Bag 	Use Contents from DAY 2 Bag 
Make sure that the patient's name, date of birth and the date of collection are written on the vial.	
Remove the cap from the BLACK top vial and add stool following the instructions on page 4.	
Place the BLACK top vial back into the DAY 1 zip-lock bag.	Place the BLACK top vial back into the DAY 2 zip-lock bag.
Store bags in refrigerator prior to shipping. <b>Do not freeze.</b>	

## DAY 3 COLLECTION

## Use Contents from DAY 3 Bag

Make sure that the patient's name, date of birth and the date of collection are written on all vials.

Remove the caps from the YELLOW top vial and the BLACK top vial and add stool following the instructions on page 4. Place the YELLOW top vial and the BLACK top vial back into the DAY 3 zip-lock bag. Store bag in refrigerator prior to shipping. **Do not freeze.**

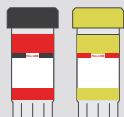

6

## SHIPPING

## PREPARE THE PACKAGE

1. Fill out the **Test Requisition**. *The test cannot be performed without a properly filled out requisition.*

- ✓ Patient name, date of birth, gender, and date of collection is recorded
- ✓ Payment type is completed and payment included, if required

2. Place **DAY 1, DAY 2 and DAY 3 collection bags into the kit box**. Place any unused vials (in collection bags) in the box. Place the Test Requisition into the kit box and close.

3. Open up the FedEx plastic Clinical Pak and affix the provided **Prepaid label onto the bag in the designated location**. Record the tracking number printed on the label if you want to track this delivery.

4. Place the cardboard box inside the Clinical Pak and seal to close.

**Please ship as soon as possible.** To obtain the best results, Doctor's Data recommends shipping specimens as soon as possible. If you cannot ship the specimens the same day you finish the collection, such as over a weekend or holiday, place the cardboard box containing the YELLOW and BLACK top vials into a refrigerator until you are ready to ship the test collection kit.

## SCHEDULE A PICK-UP (USA ONLY)

To schedule a pickup, call FedEx toll-free at 1-800-463-3339 (1-800-GO FEDEX). When you hear the automated greeting, say "Schedule a pickup." The next prompt asks if the shipment is more than 150lbs, say "No." At the next prompt, say "Schedule a Pickup with a Label or Stamp." Reply "YES" when asked if the word "Stamp" is written on the waybill. You will then be asked for your address information. **DO NOT USE A DROP BOX or leave your kit outside (especially in warm temperatures).**

In some cases, Doctor's Data provides prepaid shipping from certain countries outside the United States. If that policy pertains to this collection kit, then country specific shipping materials (including an Air Waybill and instructions) will be included in the kit contents. If there are not any shipping materials included or you choose to use a different courier or level of service than provided, you must make your own shipping arrangements at your own expense.



Culture, PCR + Parasitology

COLLECTION INSTRUCTIONS  
STOOL SPECIMEN

Read all instructions before collecting specimens.

SCIENCE + INSIGHT

# KIT CONTENTS

If you are missing kit components, call Doctor's Data at 800.323.2784 for assistance.



Kit Box

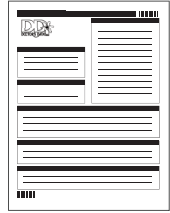

Requisition Form



FedEx Clinical Pak (USA only)



FedEx Return Label/Stamp (USA Only)

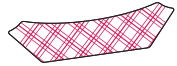

Stool Collection Containers (3)

DAY 1 BAG	DAY 2 BAG	DAY 3 BAG
<p>*BLACK top vial</p>	<p>*BLACK top vial</p>	<p>*BLACK top vial</p> <p>*YELLOW top vial</p>
Glove Absorbent material	Glove Absorbent material	Glove Absorbent material

\*The BLACK and YELLOW top vials are filled to the middle of the vial with liquid preservative. If the liquid levels fall below the middle of the vial or there is evidence of leakage, call Customer Service for assistance. **Caution:** avoid contact of the skin and eyes with the fluid in vials. If you get fluid in your eyes, flush with water for 15 minutes. If your skin comes in contact with vial fluid, wash with soap and water. If ingested, please contact a physician.

# IMPORTANT PREP INFO

**BEFORE YOU START:** Please read all of the instructions carefully before beginning. Consult your physician for specific instructions and before stopping any medications.

DISCONTINUE THE FOLLOWING	
<b>2 weeks before test</b>	Antibiotics, antiparasitics, antifungals, or probiotic supplements, proton pump inhibitors (PPIs) and Bismuth
<b>2 days before test</b>	Aspirin and other NSAIDs, digestive enzymes, laxatives (particularly mineral oil, castor oil, and glycerin enemas/suppositories), activated charcoal, betaine HCl, antacids or bentonite clay

OTHER INFORMATION		
Do not collect samples when there is active bleeding from hemorrhoids or menstruation	Wait at least 4 weeks from a colonoscopy or barium enema before collecting	Do not contaminate the stool with urine or water

WHICH BAG CONTENTS TO USE			
Patients will collect stool over 1, 2, or 3 days, depending on the order from the physician. Confirm this detail before stool collection.			
	DAY 1 BAG	DAY 2 BAG	DAY 3 BAG
Collect Stool on 3 Separate Days	1st collection	2nd collection	3rd collection
Collect Stool on 2 Separate Days	<b>X</b>	1st collection	2nd collection
Collect Stool on 1 day	<b>X</b>	<b>X</b>	only collection

# COLLECTION

## HOW TO COLLECT YOUR STOOL SAMPLE

Write the patient's name, date of birth and the date collected on each specimen vial. **The test cannot be performed without the patient information on the vials.**

1. Put on glove and collect stool into the paper collection container supplied. If possible, void urine prior to collecting stool to avoid mixing it with the stool sample.

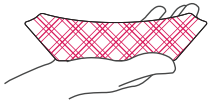

2. Remove the cap from the vial and using the attached spoon transfer stool specimen into the vial. Take multiple portions from different areas of the collection container.

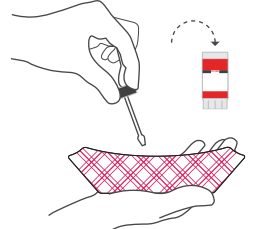

3. Add enough stool until it reaches the **fill line**. **DO NOT OVERFILL.** Screw the cap on tightly.

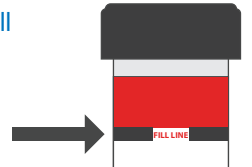

4. Shake the vial vigorously for approximately 30 seconds to mix stool with preservative.

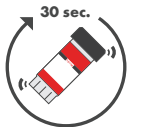

Make sure to use the correct vials for each day of collection. See Page 5 for more details.